



S



D



T

1 GENERAL INFORMATION

- **Material:** Resin
- **Weight:** 21g **S** / 38g **D** / 52g **T**
- **Fitting:** 1 minute
- **Compatible flush-mount boxes:**
LEG 080031 **S**
LEG 080032 **D**
LEG 080033 **T**



2 FINISHES



Matt Black
818

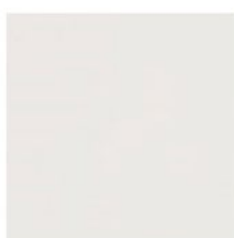

Matt white
820



Matt aluminium
822



Matt gilt
824

3 FORMATS Dimensions in mm

S

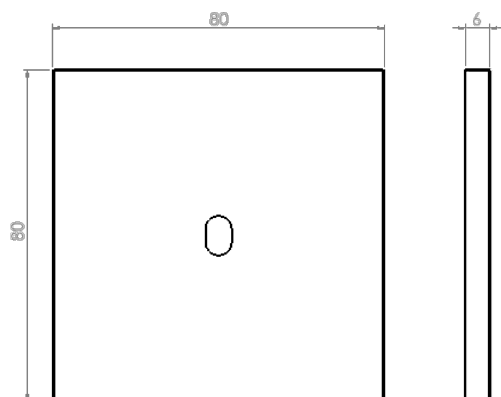

D

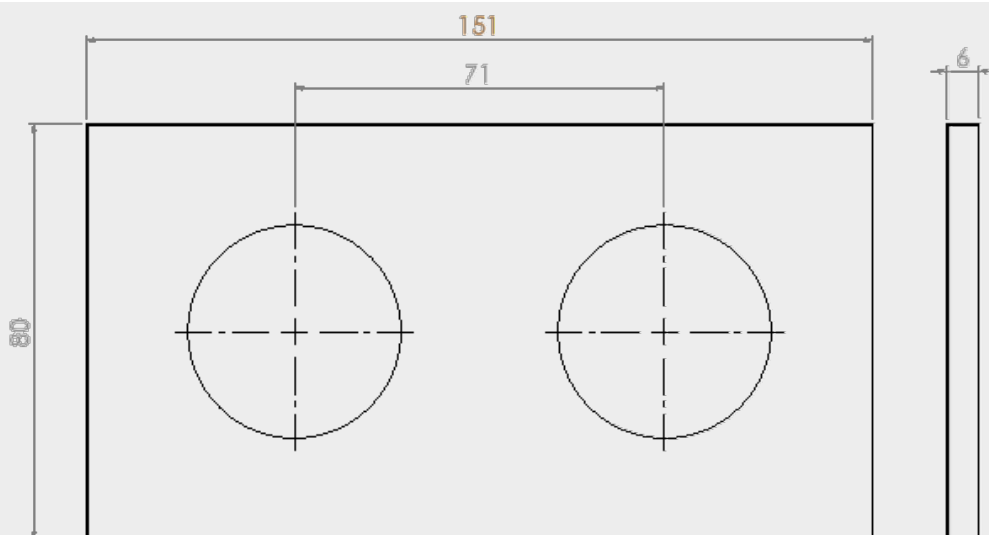

T

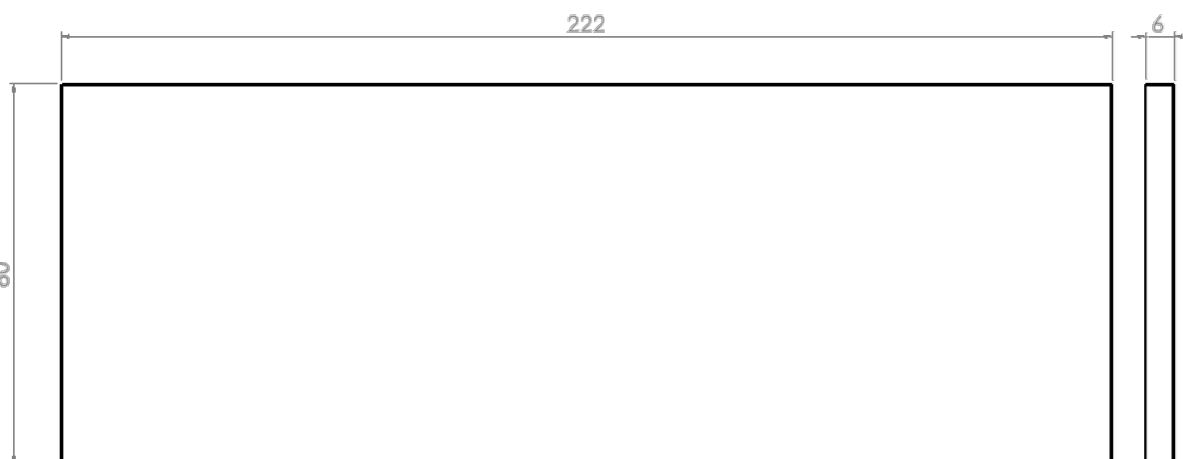

4 AVAILABLE FUNCTIONS

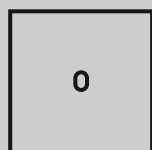

B1
1 Toggle

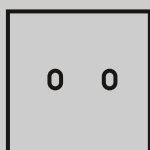

B2
2 Toggles

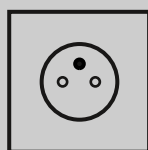

R1
2P+T
socket

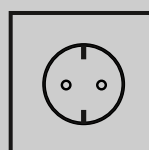

K1
Schuko
socket



U1
USB
charger



U3
Power delivery
USB C

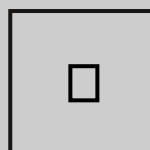

M1
1 Media

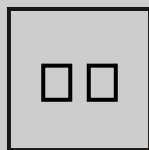

M2
2 Media

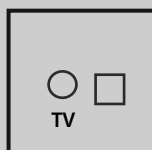

M8
TV + RJ45

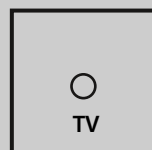

C1
TV

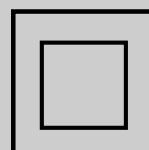

R2
Multi

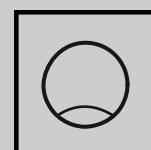

SC
Cable
outlet

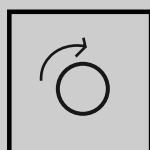

V1
Dimmer



C3
TV/FM/SAT

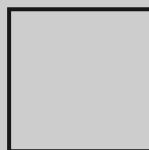

O1
Shutter

S D T

GLOSSARY

Toggle: toggle / push-button / cross switch / roller shutter

Media: RJ45 / HDMI / USB DATA / LS

Multi: presence detector / card-operated switch / international sockets

5 FITTING

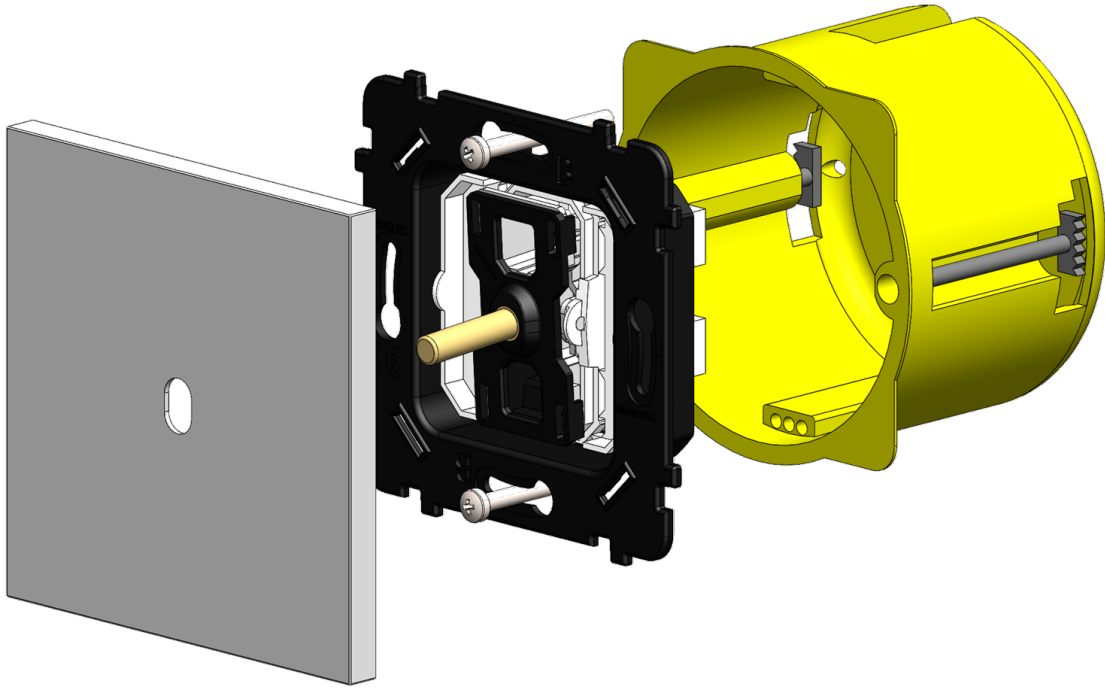

1. Wire the mechanism according to the corresponding diagram.
2. Screw on the mechanism plate using the 2 screws supplied with the box.
3. Simply snap the plate onto the mechanism by pushing the clips in to their maximum depth.