

1 INSTRUCTIONS AND RECOMMENDATIONS



Switch off the mains before commencing any work



Strip the wires back for about 12mm

Mechanisms with screw terminals



For single units, use casings 50mm deep, diameter 67 or 68mm

2 PROPERTIES AND INSTALLATION

- Device must be installed only by an authorised professional
- Use only original parts
- Do not use the product without external protection



Power supply voltage: 230V~+10%/-15% 50Hz

Adjustment range: +5% at +30°C

Operating temperature: 0°C to 50°C

Storage temperature: -20°C to +60°C

Output relay: μ 8A AC1

Class: II

Protection index: IP20

Connection capacity: 1 x 1.5mm
1 x 2.5mm²

Operating mode retained indefinitely

Inertia = -1°C high inertia / -3°C low inertia

Maximum permitted power 8A per circuit

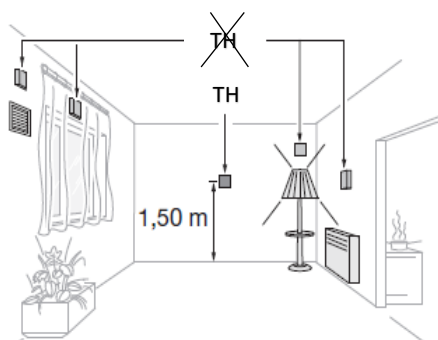

Suitable for all types of heating and air conditioning systems

Care must be taken, however, for an inverter system. Switching between "heating" and "air-con" modes uses a mechanical operation on the mechanism. (see below for explanation)

The room thermostat should be fitted about 1.5m above the floor, on an interior wall.

Protect from direct sunlight and thermal interference such as light bulbs, television sets, heating pipes and draughts.

How the thermostat works

- OFF position: thermostat off. Position used to check the type of regulation (high/low inertia).
- Position (manual): the thermostat does not respond to pilot wire commands.
- AUTO position: the temperature is controlled from commands via the pilot wire. The comfort temperature is that set with the central button.

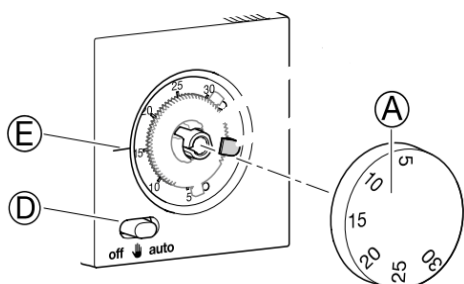

- (D) Switch OFF / Manual / Auto.
 (E) Temperature indicator.
 The switch lights up when the heating is on.

Principle of the 6-order pilot wire

This connection to a programmer or energy manager allows the heating to be controlled in automatic mode as follows:

- Comfort temperature = temperature set on the thermostat.
- Reduced temperature = economy temperature used during the night or short absences.
- Frost-free temperature: 7.5°C fixed.
- Off = heating off (load shedding).
- Eco 1/ Eco 2 = temperature level set by an energy manager during the sensitive periods of the Temp option.

3 WIRING

 **N** neutral – blue cable

 **L** phase – red cable

  earth – green/yellow cable

Direct connection:

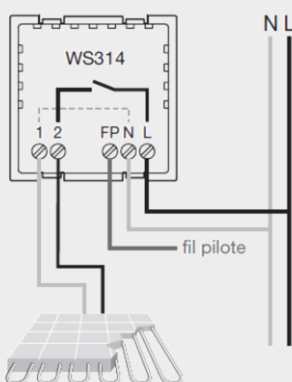

Connection with external relay:

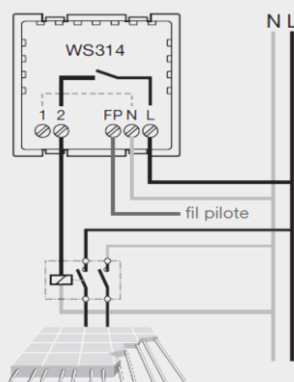

Connect the heating directly to the output terminals (unswitched neutral) for underfloor heating below 8A (1800W).

However, for optimal thermostat operation, the heater should preferably be connected via a relay for any value greater than 4.5A (1100W).

4 THERMOSTAT SETTING

CHANGE OF INSTALLATION TYPE (LOW/HIGH INERTIA)

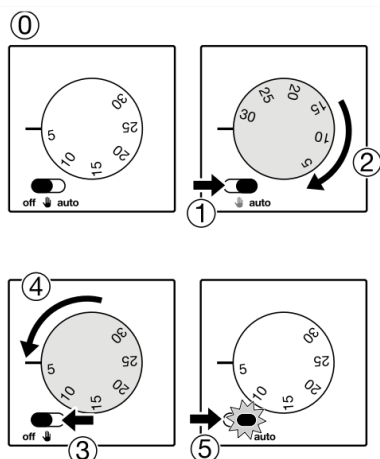

The thermostat is delivered in "high inertia" mode (electric floor heating). To switch to low inertia (conventional convector heating) follow the sequence described:

0- To start, set the switch to OFF and the temperature to "low stop".

1- Set the switch to AUTO.

2- Set the temperature to "high stop".

3- Set the switch to OFF.

4- Set the temperature to "low stop".

5- Set the switch to AUTO.

At the end of the sequence, the switch flashes rapidly for 3 seconds to indicate the change to low inertia mode and flashes 3 times in 3 seconds for high inertia.

If more than 15 seconds elapse between the different steps, the sequence must be restarted at step 0.

CHECKING OPERATING MODE

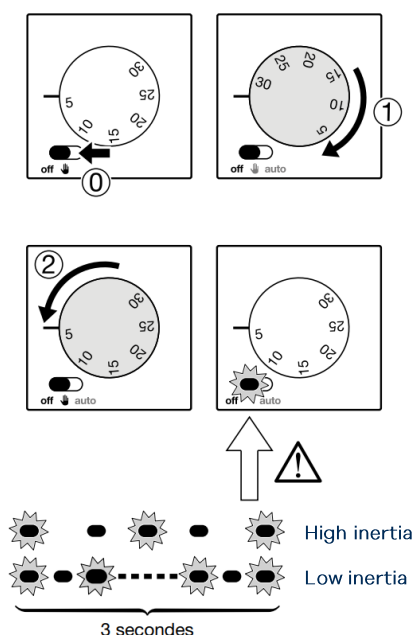

0- Set the switch to OFF.

Set the temperature to the "low stop".

1- Set the temperature to "high stop".

2- Return to "low stop".

The switch flashes 3 times in 3 seconds: high inertia (electric floor heating).

The switch flashes rapidly for 3 seconds: low inertia (conventional convector).

Caution: Steps 0 to 2 must be completed within 10 seconds.

This operation does not affect the thermostat settings and can be done any time.

5 FITTING

After wiring according to the instructions, place the mechanism in the flush-mount box screw on the plate, and put the bezel on as shown in the diagram opposite.

Screws supplied with the flush-mount box.

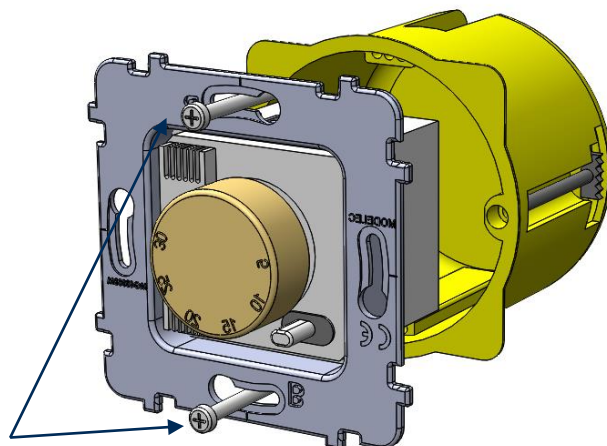

6 TABLE OF RELEVANT REFERENCES

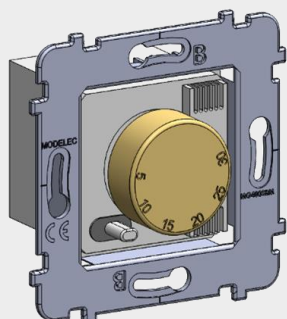

Reference and description:

087-291G Pilot wire thermostat

Compatible with:

Confidence Collection

7 CERTIFICATIONS

